

LEGEND	
	DIRECTION OF VEHICULAR EGRESS
	DIRECTION OF INTERIOR EGRESS
	DIRECTION OF AREA EGRESS w/ NUMBER OF OCCUPANTS INDICATED
	ACCESSIBLE ROUTE
	FIRE DEPARTMENT ACCESS
	FIRE DEPARTMENT KNOX BOX
	FIRE DEPARTMENT CONNECTION
	PROPOSED CONTOUR LINES
	STANDPIPE HOSE CONNECTION
	FIRE HYDRANT

GENERAL NOTES

- BUILDING HEIGHT:** TYP. 32' ABOVE GRADE.
- DETENTION:** ALL WATER DETENTION IS REGIONAL AND PROVIDED OFF-SITE.
- FIRE LANE SIGNAGE:** 'NO PARKING FIRE LANE' SIGNS, IN ACCORDANCE WITH IFC 2015 SECTION D103.6 WILL BE PROVIDED ALONG THE PRIVATE DRIVE ON THE EASTERN EDGE OF SITE.
- FIRE PROTECTION:**
 - CONSTRUCTION TYPE VA; FULLY SPRINKLED BUILDING (NFPA 13R).
 - ALL UNITS PROVIDED WITH SMART BURNER RANGES.
 - WINDOWS: EMERGENCY ESCAPE & RESCUE OPENINGS PROVIDE MORE THAN MINIMUM AREA FOR EGRESS AS PER IBC 2015.
 - NO CONCIERGE TRASH SYSTEM IN PLACE.

SUBMITTAL TYPE	DATE
MAJOR SITE PLAN	10.11.2018
MAJOR SITE PLAN - 2nd SUBMITTAL	02.07.2019

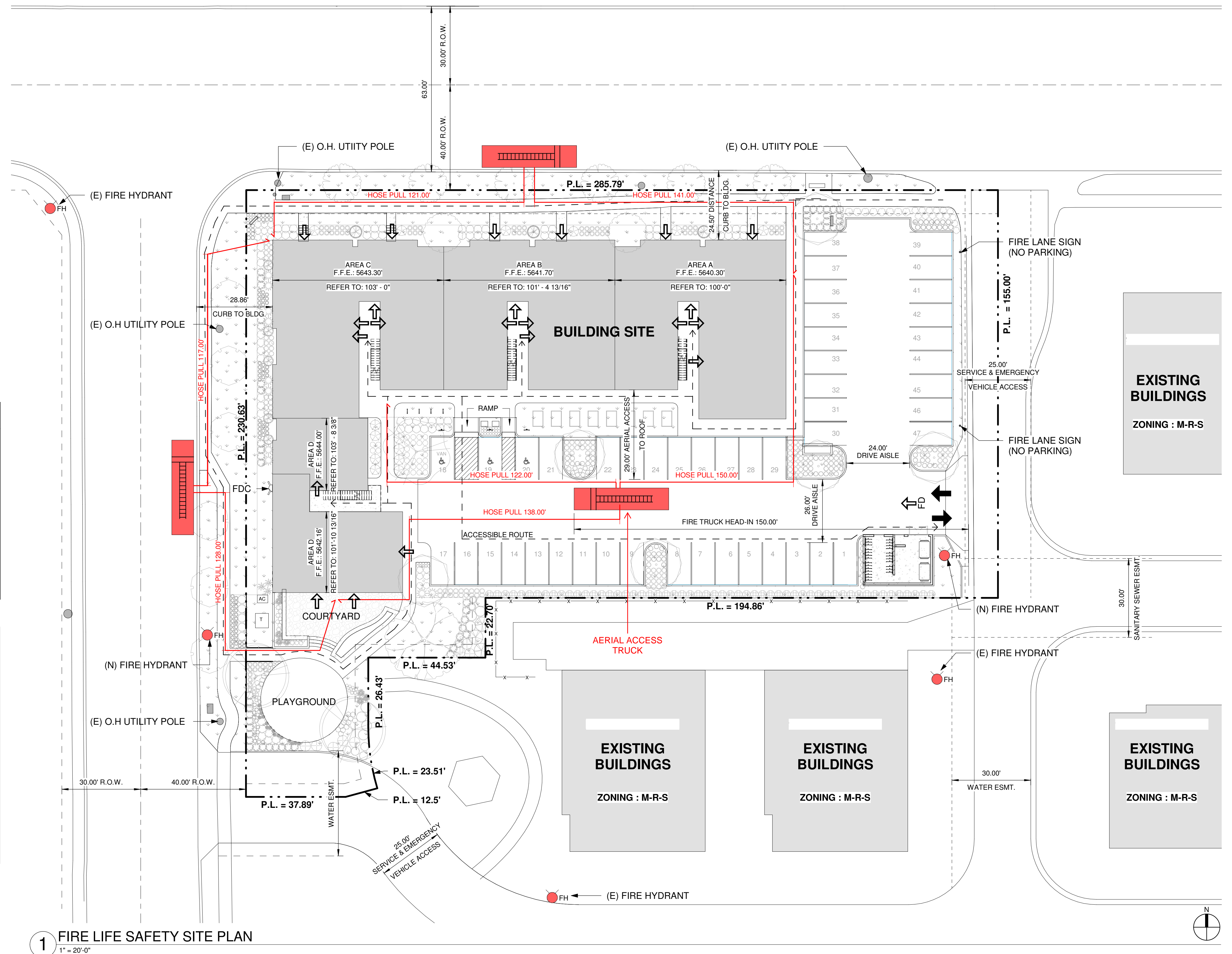

1 FIRE LIFE SAFETY SITE PLAN
1" = 20'-0"